

K2 POWER ES 130 K

Woofer 5"



- K2 Power sandwich cone
- "TMD" surround (patented technology)
- Aluminum compact basket

SPECIFICATIONS

Nominal power	80W	
Maximum power	160W	
Sensitivity (2,83V/1m)	90dB	
Cone	Kevlar sandwich	
Nom. impedance	4Ω	
Surround	Butyl	
DC resistance	3Ω	
VC diameter	25mm	0.6364"
Former	Kapton	
Layers	2	
Wire	CCA	
Magnet (dxh)	80x17mm	0.315x0.4364"
Net weight	800g	1.76lbs

FREQUENCY RESPONSE/IMPEDANCE

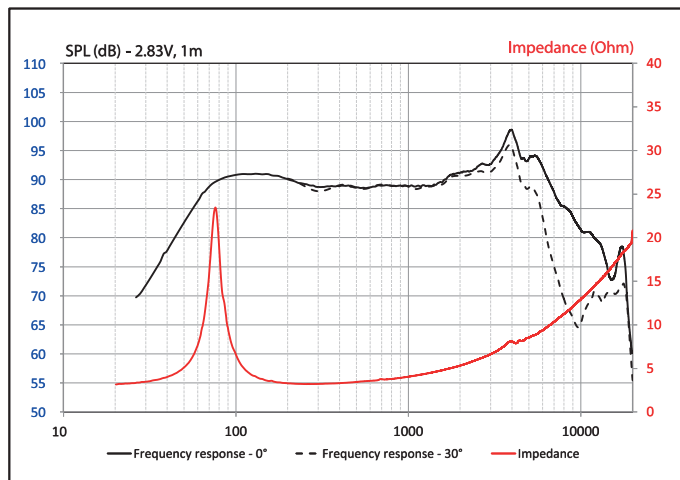

PARAMETERS

R _{dc}	3 Ω
F _s	78Hz
M _{ms}	9.4g
C _{ms}	0.4mm/N
V _{as}	4.3l
Q _{ts}	0.82
Q _{es}	0.949
Q _{ms}	6.7
B _{xl}	3.9 N/A
S _d	83.3cm ²
SPL	87.2dB
X _{max}	4.5mm

MECHANICAL DRAWING

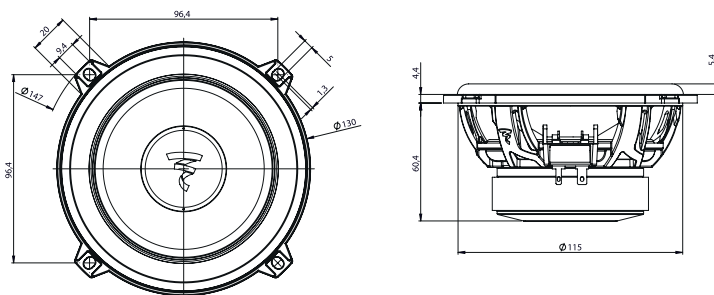

 **Elite**
"HAUTE COUTURE" SOUND

 **FOCAL**
THE SPIRIT OF SOUND